

CONDOMINIUM MAP - BUILDING "F"

A PARCEL LOCATED IN THE NE1/4 OF THE NW1/4 OF SECTION 3,
T. 18 N., R.105 W., OF THE SIXTH PRINCIPAL MERIDIAN,
SWEETWATER COUNTY, WYOMING

| COMMERCE - CONDOMINIUM MAP | | |
|----------------------------|-------------|---------|
| BUILDING "F" - BASEMENT | 0.201 ACRES | 3 UNITS |
| BUILDING "F" - 1ST FLOOR | 0.291 ACRES | 1 UNIT |
| BUILDING "F" - 2ND FLOOR | 0.246 ACRES | 2 UNITS |
| BUILDING "F" - 3RD FLOOR | 0.236 ACRES | 2 UNITS |
| BUILDING "F" - 4TH FLOOR | 0.173 ACRES | 2 UNITS |

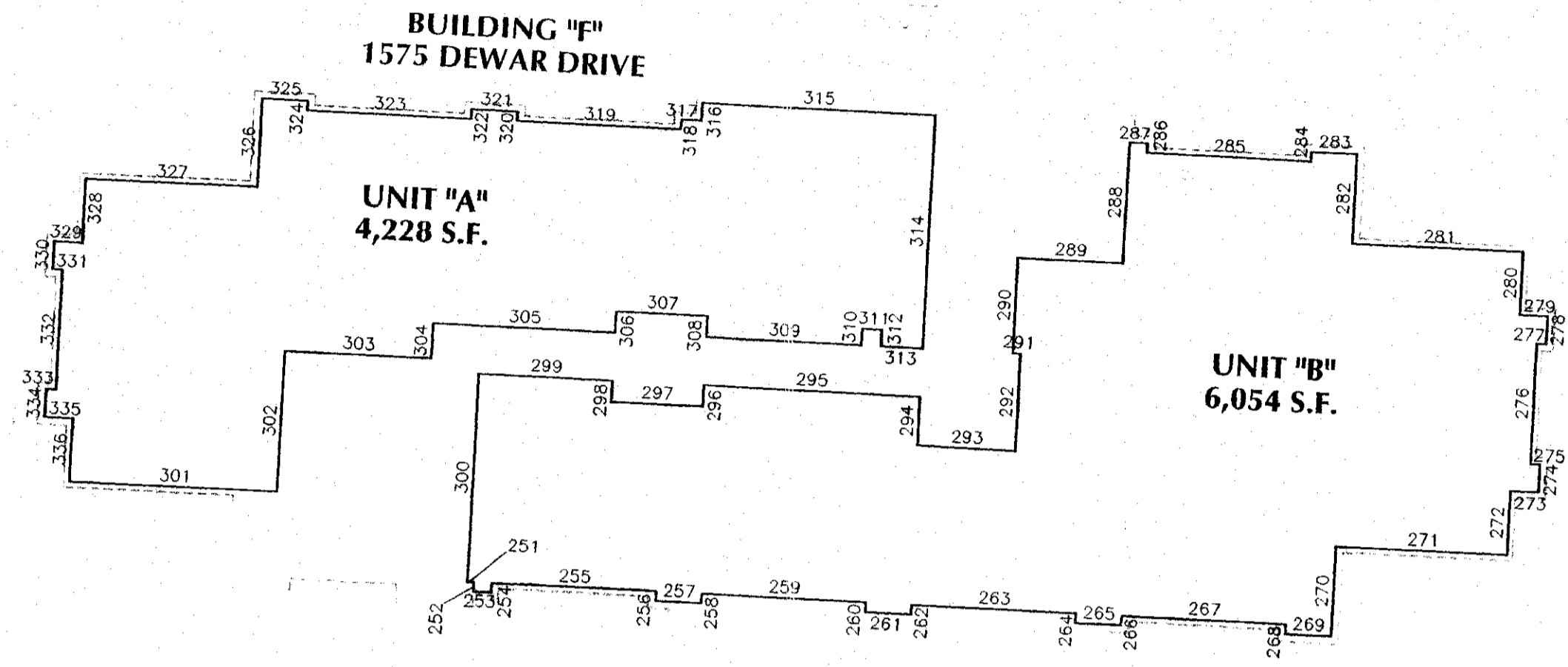

THIRD FLOOR

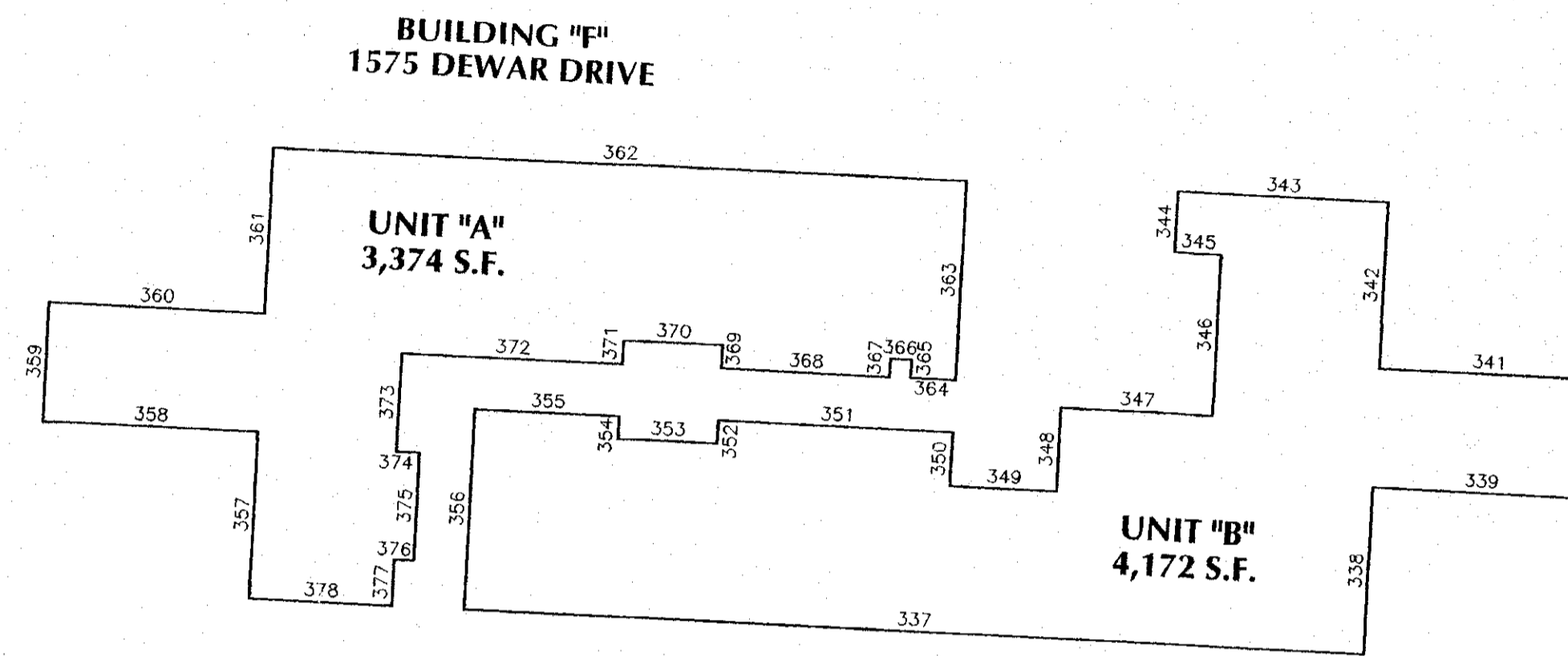

4TH FLOOR

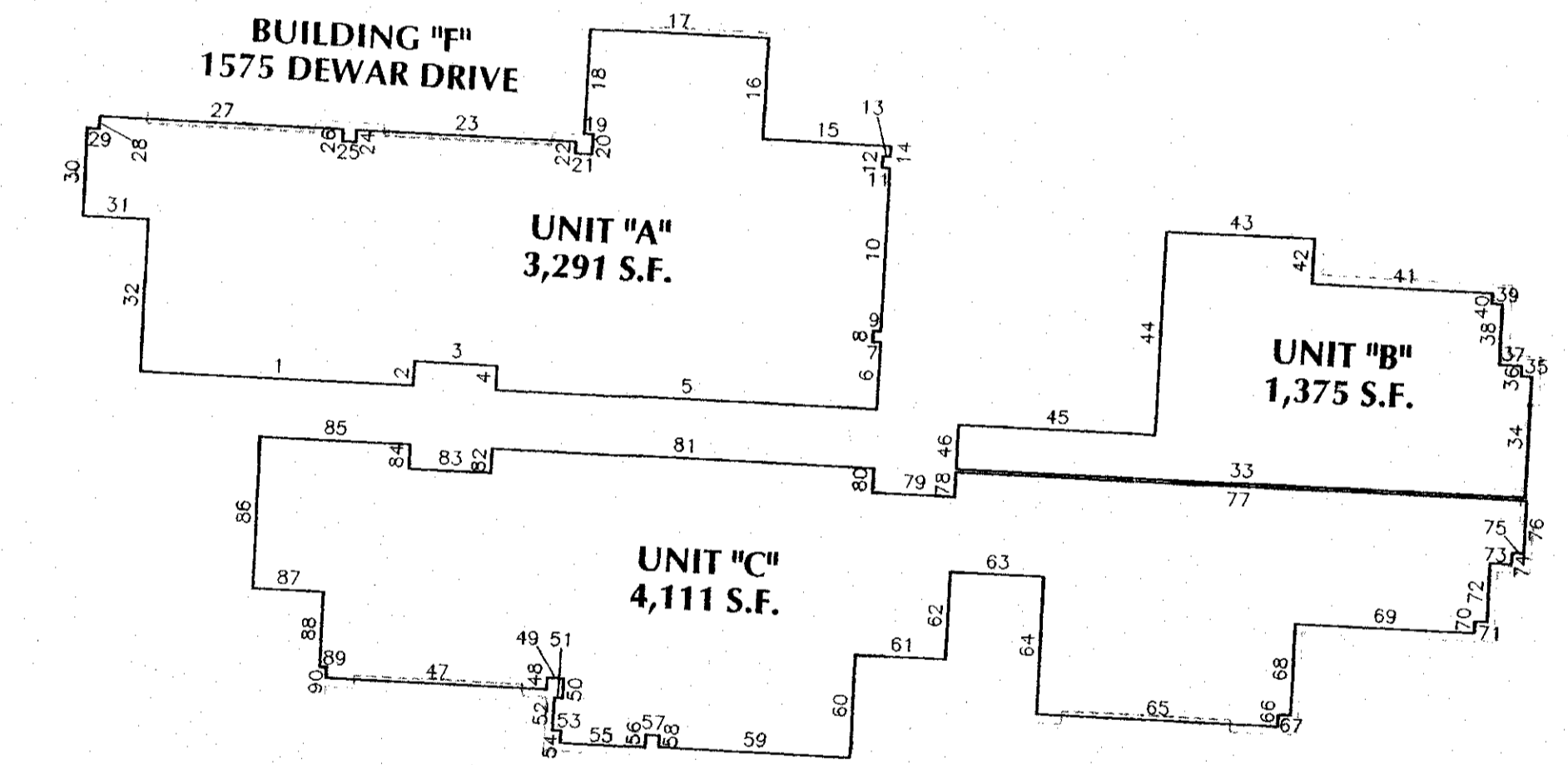

BASEMENT LEVEL

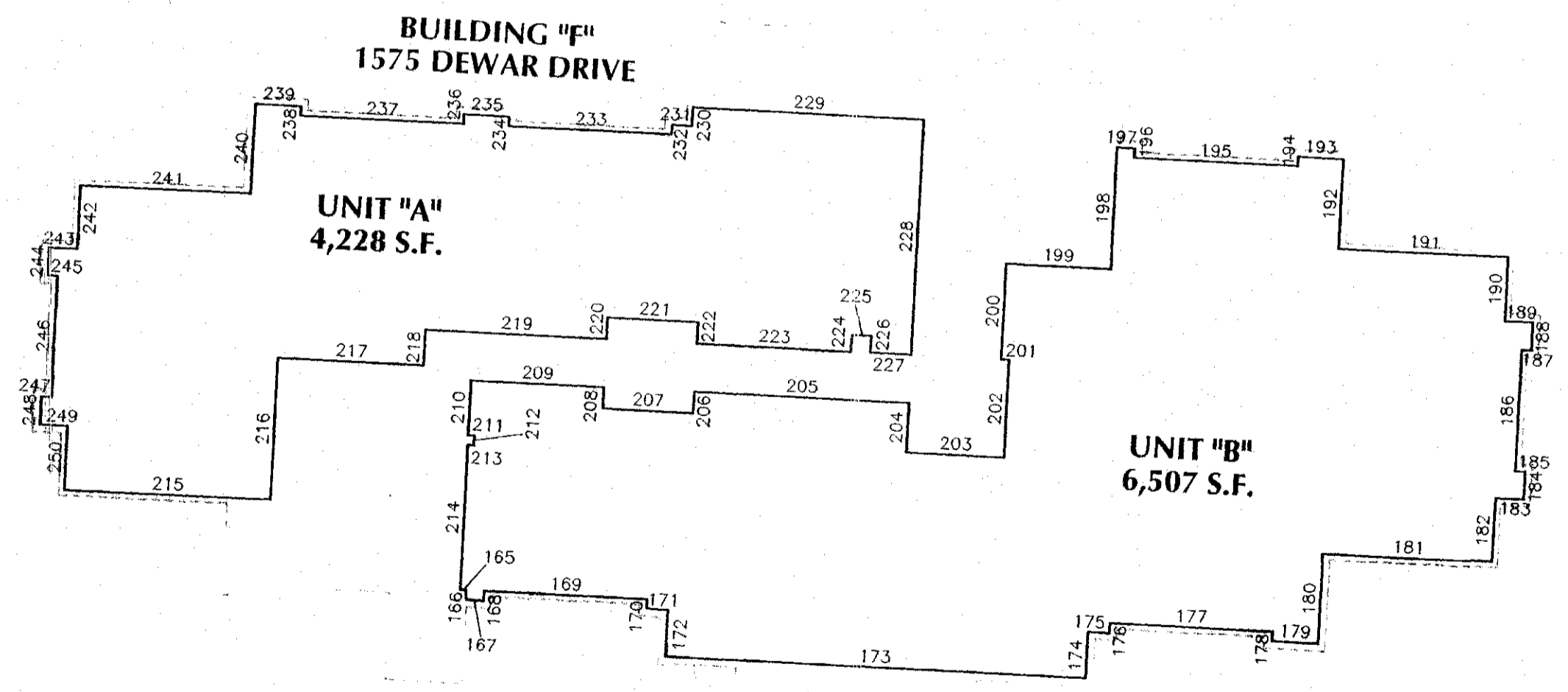

SECOND FLOOR

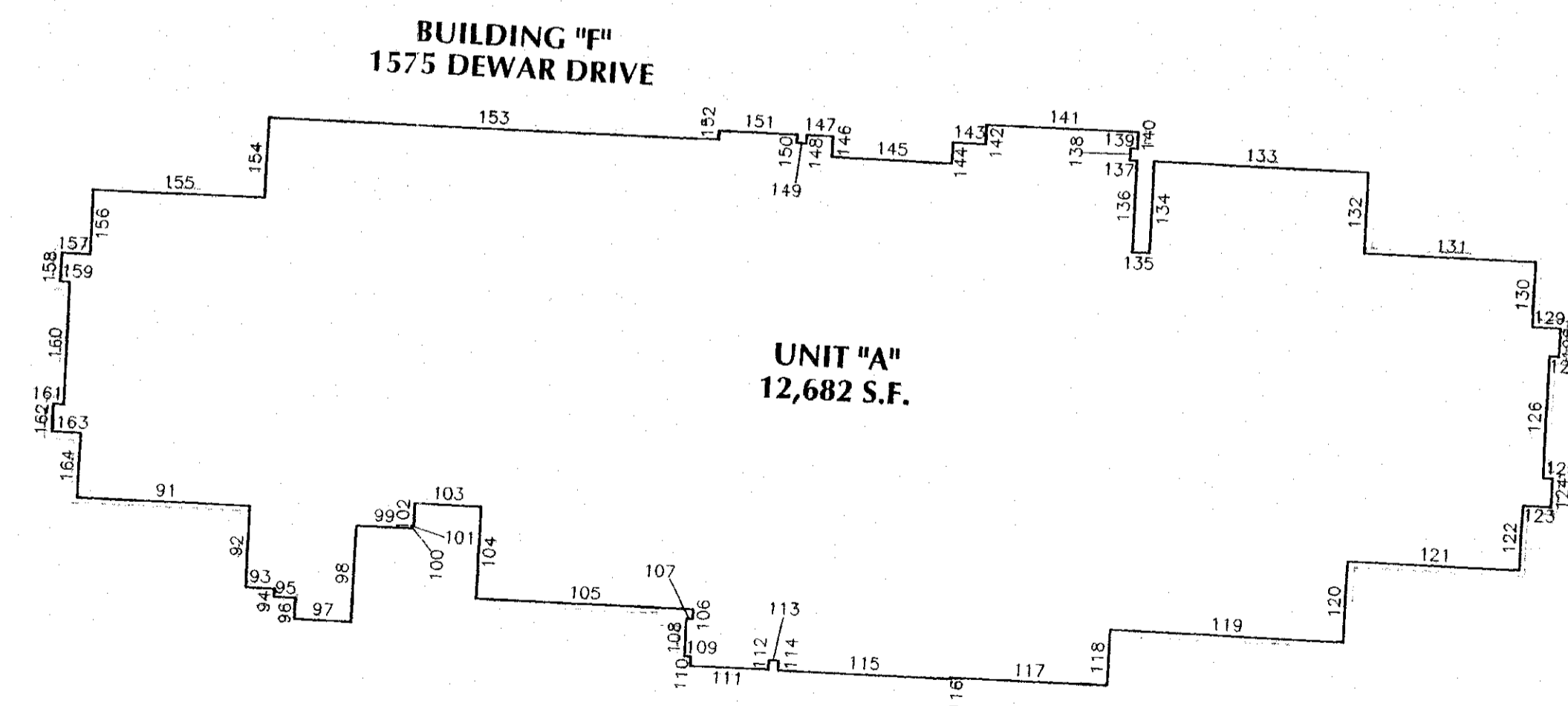

FIRST FLOOR

CHOICE ENGINEERING SERVICES

404 "N" Street - Suite 201 | Rock Springs, WY 82901
Phone 307-362-6065 | Fax 307-362-6064

DATE OF PREPARATION: 07/31/09

RECORDED 6-27-2009 AT 04:38 PM REC# 1555477 Bk# 0000 PGM 0006
STEVEN DALE DAVIS, CLERK OF SWEETWATER COUNTY, WY Page 7 of 8

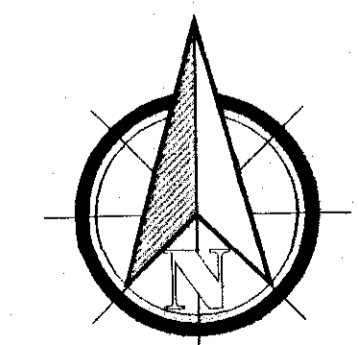

0 20 40
SCALE: 1" = 20'